

## Extended Type Hose Couplings for Vapor and Liquid Service

Designed especially for liquid filling and vapor equalization of LP-Gas and anhydrous ammonia. The limited travel of the handle on the tail-piece minimizes spin-off, encouraging cautious removal to properly bleed off trapped product to assure closure of the filler valve and hose end valve. The ACME threads are machined on a rugged steel insert which is permanently cast in the aluminum handle, providing for durability under repeated use.

Part Number	Type of Service	Hose Connection (M. NPT)	Coupling Connection (F. ACME)	Approx. Length
A7575L2*	Liquid	1/2"	1 3/4"	7"
A7575L3		3/4"		
A7575L4		1"		
A7575L5**		1 1/4"		
A7571LA	Vapor	1/2"	1 1/4"	
A7571LB		3/4"		

\* Includes 7199-33 adapter, shipped loose.

\*\* Includes A7575L5-1 adapter, shipped loose.



A7571 Series



A7575 Series

## Short Type Hose Couplings for Vapor and Liquid Service



Style A  
For Liquid Filling



Style B  
For Liquid Filling



Style C  
For Vapor Equalizing



Style D  
For Vapor Equalizing



Part Number	Material	Style	Hose Connection (M. NPT)	Coupling Connection (F. ACME)	Tailpiece Bore	Hose End To Nut	Overall Length
3175B	Brass	A	1/2"	1 3/4"	35/64"	2"	2 7/8"
3175			3/4"		3/4"		
3175A			1"				
3185		B	1 1/4"	2 1/4"	1 3/16"	2 1/16"	3 1/8"
3195	Brass Nut & Steel Nipple	B	2"	3 1/4"	1 13/16"	2 1/8"	3 5/8"
A3175	Steel	A	3/4"	1 3/4"	3/4"	2"	2 7/8"
A3175A			1"				
A3185		B	1 1/4"	2 1/4"	1 3/16"	2 1/8"	3 1/8"
A3195			2"	3 1/4"	1 13/16"	2 1/8"	3 5/8"
3171	Brass	C	3/8"	1 1/4"	13/32"	1 3/16"	2 7/16"
3171A			1/2"		17/32"		
3181			3/4"		1 1/16"		
3181A		1"	1 5/16"	1 7/8"	3 1/8"		
3191		D	1 1/4"	2 1/4"	1 3/16"	2 1/8"	3 5/16"

## ACME Wrench

Part #	Description
J Wrench	For 3 1/4" ACME
Wrench IC2	For 3 1/4" ACME



Wrench IC2

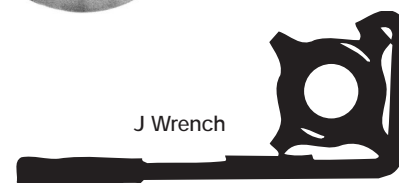

J Wrench

## ACME Check Connectors for Lift Trucks

These brass connectors are especially designed to join the carburetor fuel line to the service valve on lift truck cylinders. Sturdy, long lasting ACME threads allow quick, hand-tight assembly that provides for quick and simple cylinder replacement. Back checks automatically close in each connector when disconnected.

The 7141M couples directly to the service valve. An integral O-ring is designed to seal before the internal check opens, aiding in product loss prevention. A gasket at the ACME thread is a secondary seal when the connectors are tightened together. The connector fits RegO® lift truck cylinder filling adapters for fast, convenient filling.

The 7141F accepts fuel line adapter and couples directly to the 7141M. The O-ring seal in the 7141M is designed to seal before the internal check opens to allow product to pass through the connection. The knurled coupling eases threading and the ACME threads provide rapid effortless make-up, even against LP-Gas pressure.



7141M



7141F

Part Number	Application	Inlet	Outlet	Protective Cap*		Repair Parts**
				Rubber	Brass	
7141M	Service Valve	3/8" F. NPT	1 1/4" M. ACME	7141M-40	7141FP	Gasket 7141M-3R (25 Per Pkg)
7141F	Fuel Line	1 1/4" F. ACME	1/4" F. NPT	—	—	O-Ring 7513-25

\* Recommended to minimize foreign material entering valves which could result in leakage.

\*\* See page 82 for size chart.

## Unloading Adapters for Container Evacuation

Designed to provide an efficient means of evacuating an LP-Gas container for relocation or repair. They thread directly onto the 1 3/4" ACME male hose connection of RegO® Filler Valves used on RegO® Double Check Filler Valves and Multivalves®.

The unloading adapters can be used to withdraw liquid provided the container is equipped with a dip pipe extending from the filler valve to the bottom of the container.

Part Number	Style	Filler Valve Connection	Hose Connection
3119A	In-Line	1 3/4" F. ACME	1 3/4" M. ACME
3120	Angle		3/4" F. NPT
3121			



3119A



3120



3121

## Filler Hose Adapters

These adapters are designed with minimal flow restriction and recommended for use on the outlet of the LP-Gas delivery truck filler hose. If the controlled bleed off of the connection indicates the filler valve on the tank being filled has failed to close, the hose adapter should be left in place on the filler valve and disconnection should be made at the regular filler hose coupling. (Repair of the filler valve must be made as soon as possible). An integral check valve in these adapters helps prevent further loss of product. The standard filler valve cap should be attached to these adapters when left on the container.

Part Number	Built-in Vent Valve	Filler Valve Connection	Hose Connection
7577V	Yes	1 3/4" F. ACME	1 3/4" M. ACME
3179B	No		



3179B



7577V

## Hose End Adapters for DOT Cylinder Filling

Designed to provide quick and easy filling of DOT cylinders with POL or Type I connections. This adapter may be used with hydraulic and electric automatic systems or with manual systems in conjunction with a RegO® 7901TB Quick Acting Shut-Off Valve.

These filling connectors have an extended connection on the handwheel, which makes it possible to connect the loading hose to valves on cylinders with fixed collars. The handwheel is well outside the collar for easy operation.

Part Number	Application	Inlet Connection	Outlet Connection	Materials
7193D-10	Filling of DOT Cylinders with POL Connections	¼" M. NPT	M. POL (CGA 510)	Brass and Stainless Steel
7193U-10	Filling of DOT Cylinders with Type I Connections		Type I Connection (1½" M. ACME)	Brass

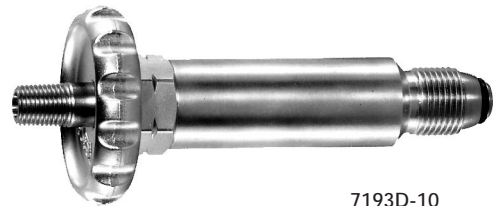

7193D-10

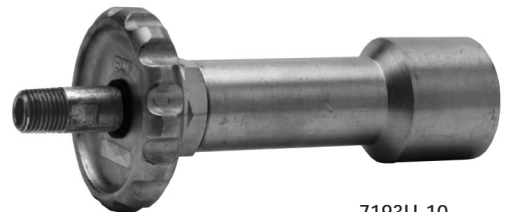

7193U-10

## Connector for DOT Cylinder Filling Adapter

The 7193T-10 is designed for use on the 7193D-10 Filling Adapters. Connector allows adapter to be used on the 1½" M. ACME & F. POL connections of Type 1 valves.

Part Number	Application	Inlet Connection	Outlet Connection	Materials
7193T-10	Converts 7193D-10 Adapter from POL to a Type 1 Connection	M. POL CGA 510	Type 1 Connection (1½" M. ACME)	Brass

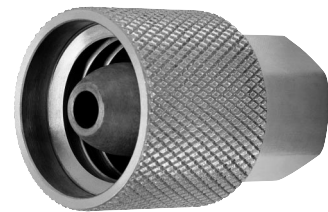

7193T-10

## Hose End Adapter for Lift Truck Cylinder Filling

The 7193L-10A is designed to provide quick and easy attachment of the filling hose to DOT cylinders equipped with RegO® 7141M check connectors.



Part Number	Application	Inlet Connection	Outlet Connection	Body Material	Accessories
					Adapter
7193L-10A	Filling of Fork Lift Cylinders*	¼" M. NPT	1¼" F. ACME	Brass	5760A

\* The 7193L-10A is intended to be permanently attached to the filling hose.  
A 5760A adapter enables the 7193L-10A to be attached to the POL connection on the 7193D-10 at regulator cylinder filling stations to allow for occasional filling of fork lift cylinders.

## Lever Operated Hose End Adapter for Fork Lift Cylinder Filling

Designed to drastically reduce labor and time when continuously filling large numbers of lift truck cylinders equipped with RegO® 7141M check connectors.

Part Number	Application	Inlet Connection	Outlet Connection	Materials
7193K-10B	Lever Operated for Quick Filling of Fork Lift Cylinders	¼" F. NPT	Quick Disconnect Yoke*	Brass and Steel

\* For use with RegO® 7141M check connector.

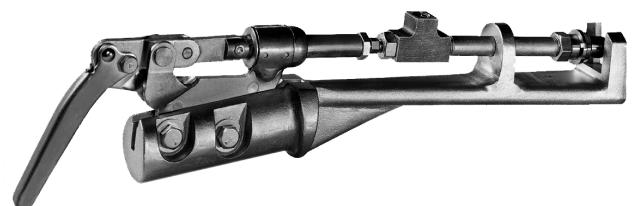

## ACME Plugs

Specifically designed to withstand the everyday abuse given hose end valves on delivery trucks and hose end couplings on risers in bulk plants. These rugged plugs protect the coupling tip as well as prevent the entrance of dirt, dust, snow and rain. They also prevent possible gas contamination from these same sources. The heavily ribbed outer surface permits hand-tight make-up.

Part Number	Material	(M. ACME)	Chain & Ring Fits Pipe Size Up To:
C5763N	Nylon	1 1/4"	3/4"
C5765N		1 1/4"	1 1/4"
5765PR	Brass		Not Applicable
C5767N	Nylon	2 1/4"	1 1/4"
C5769N		3 1/4"	2"



## POL Plugs

Highly recommended for installation in LP-Gas cylinder valve POL outlets whenever the service line is disconnected or when the cylinder is being transported.

When properly installed, the POL plug is designed to prevent contamination of the valve outlet and guards against product leakage if the cylinder valve is accidentally opened.

Part Number	Material	Connection
970EZP	Plastic	M. POL (CGA 510)
10538P	Brass	
3705RC		



**10538P**  
(Has hole for attaching wire to prevent loss of plug)

## Caps and Reducers

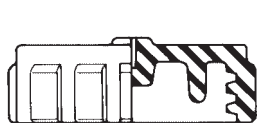

**3144-91**  
Plastic Cap

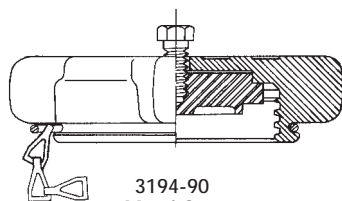

**3194-90**  
Metal Cap

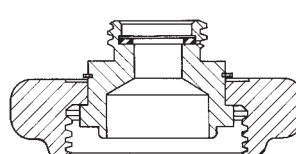

**5776**  
Reducer Coupling

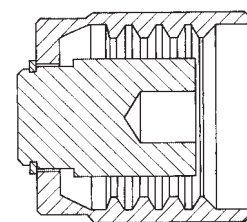

**7141FP** Cap Plug

Cap With Chain & Ring		Cap Only Part Number	Material	Thread Connection	
Part Number	Ring Fits Pipe Size Up To:				
3144-91	3/4"	3144-9P	Cyclac	1 1/4" F. ACME	
3174-91		3174-9P		1 3/4" F. ACME	
3174-93		1 1/4"	A8016-9P	Nylon	F. POL (CGA 510)
A8016-93	—		—	Brass	1 1/4" F. ACME
1708C		3/4"			1 3/4" F. ACME
7141FP		1 1/4"			2 1/4" F. ACME
3175P		2"			3 1/4" F. ACME
3184-90	2"	3194-9	Steel	2 1/4" F. ACME	
3194-90	3"	5776*		3 1/4" F. ACME	
—	—	—	Steel	2 1/4" F. ACME	
A3184-90	2"	—		3 1/4" F. ACME	
A3194-90	3"	—		3 1/4" F. ACME	
—	—	A5776*	—	—	

\* Reduces to 1 3/4" M. ACME

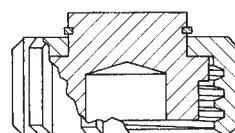
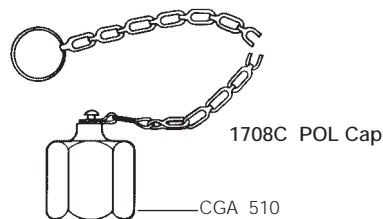

**3175P** Cap Plug

## Washers (Actual Size)

Part #	Use	Size
7141M-3R	Fork Lift Conn.	1 1/4" ACME
A2697-20R	Filter, Vapor Valve & Adapter Connections	1 3/4" ACME
A2797-20R		1 1/4" ACME
A3184-8R		2 1/4" ACME
A3194-8R		3 1/4" ACME



7141M-3R



A2797-20R

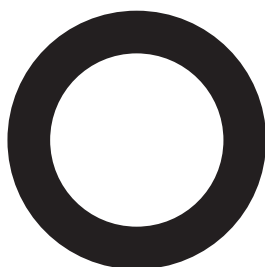

A2697-20R

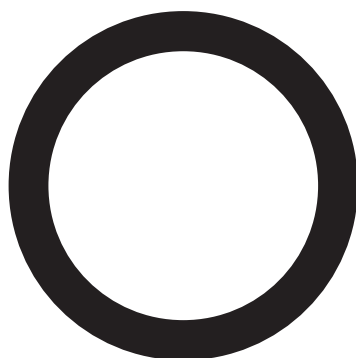

A3184-8R

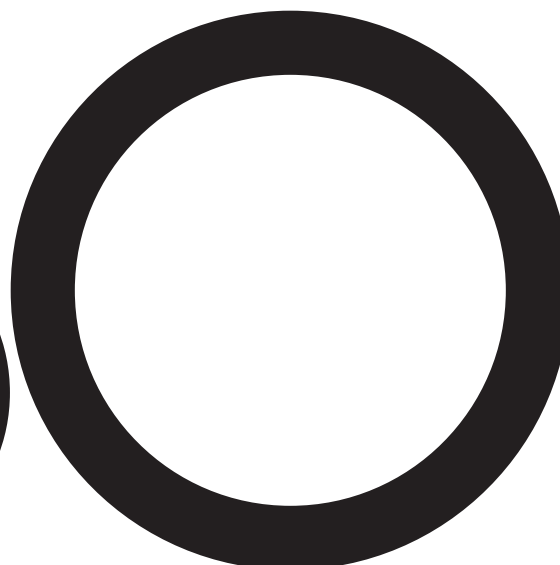

A3194-8R

## Buna-N O-Rings (Actual Size)

Part #	Use	Size
7193-1	POL Nipple	POL
7513-25	Internal Fork Lift	1 1/4" ACME
A3184-20R	Filler, Vapor Valve & Adapter Connections	2 1/4" ACME
A3194-20R		3 1/4" ACME



7193-1

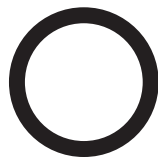

7513-25

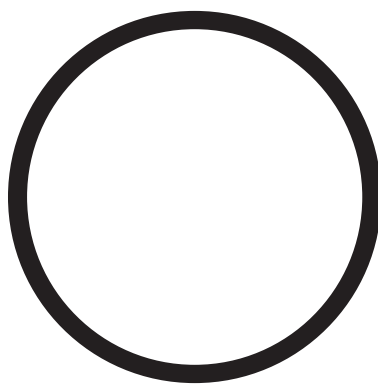

A3184-20R

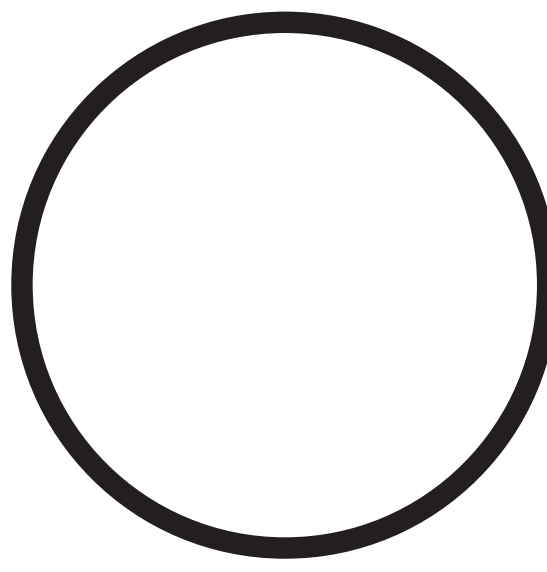

A3194-20R

## ACME Adapters

Part Number	Material	A M. ACME	B F. NPT	C Hex	D	E Diameter	For Spare Gasket Order Part No.	
5764A	Brass	1 3/4"	1/4"	1 3/4"	1 1/2"	3/4"	A2697-20R	
5764B			3/8"					
5764C			1/2"					
5764D			3/4"					
5764E			1"					
5766E		2 1/4"	1"	2 1/4"	2 5/16"	1 3/8"		A3184-8R
5766F			1 1/4"					
5768G			1 1/2"					
5768H		3 1/4"	2"	3 1/2"	3 5/8"	2 1/8"		A3194-8R
5768J			2 1/2"					
A5764D	Steel	1 3/4"	3/4"	1 3/4"	2 3/16"	3/4"	A2697-20R	
A5764E			1"					
A5768H		3 1/4"	2"	3 1/4"	3 1/4"	1 13/16"	A3194-8R	

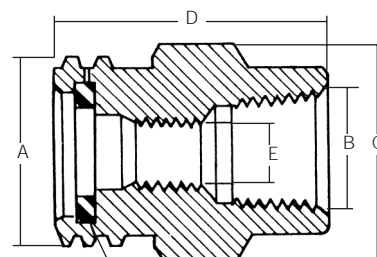

Gasket (Furnished with adapter)

ACME x Female NPT

Part Number	Material	A M. ACME	B M. NPT	C Hex	D	E Diameter	For Spare Gasket Order Part No.	
5763D	Brass	1 1/4"	3/4"	1 1/4"	1 3/4"	7/16"	A2797-20R	
5765D		1 3/4"	3/4"	1 3/4"	2 1/8"	3/4"	A2697-20R	
5765E			1"					
5765F			1 1/4"					
5767F			1 1/4"					
5767G		2 1/4"	1 1/2"	2 1/4"	2 5/16"	1 3/16"	A3184-8R	
5767H			2"					
5769H		3 1/4"	2"	3 3/8"	3 1/2"	2 7/8"	1 7/8"	A3194-8R
5769J			2 1/2"	3 1/4"				
5769K			3"	3 1/2"		3 5/8"		
A5765C	Steel		1 3/4"	1/2"		1 3/4"		
A5765D		3/4"		1 1/16"				
A5765E		1"		7/8"				
A5765F		1 1/4"		15/16"				
A5767F		2 1/4"	1 1/4"	2 1/4"	2 3/8"	1 3/16"	A3184-8R	
A5769H		3 1/4"	2"	3 1/4"	2 7/8"	1 7/8"	A3194-8R	
A5769K	3"		3 1/2"		3 13/16"	2 1/8"		

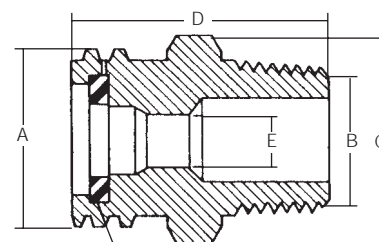

Gasket (Furnished with adapter)

ACME x Male NPT

Part Number	Material	A M. ACME	B Hex	C	D Diameter	For Spare Gasket Order Part No.
5765M	Brass	1 3/4"	1 3/4"	2 1/16"	7/8"	A2697-20R
5767M		2 1/4"	2 1/4"	2 5/16"	1 25/64"	A3184-8R
5769M		3 1/4"	3 1/4"	2 3/4"	2 1/8"	A3194-8R

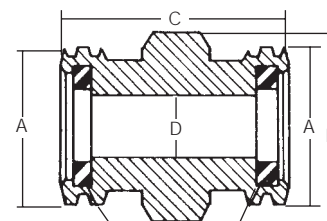

Gasket (Furnished with adapter)

ACME x ACME

Part Number	Material	A M. ACME	B Thread	C	D Hex	For Spare Gasket Order Part No.
A5764W	Steel	1 3/4"	3/8" *	1 1/4"	1 11/16"	2697-20

\* 3/8" -16 UNC Thread.

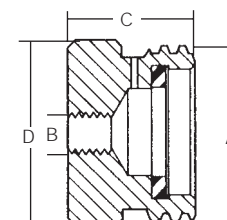

ACME x Miscellaneous  
(Recommended for securing hose-end valve when not in use).

## Male POL Swivel Adapters

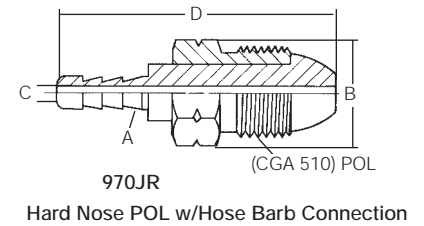
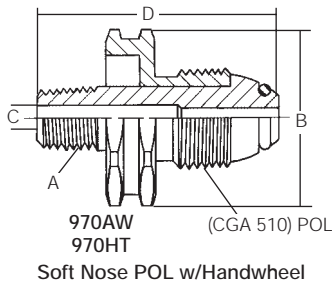
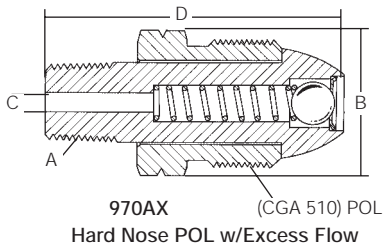
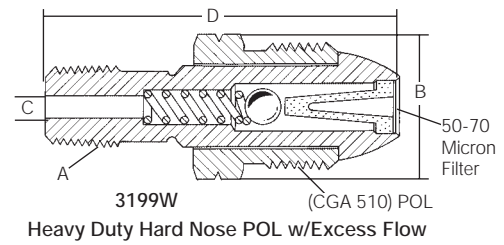
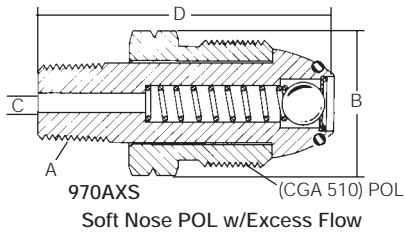
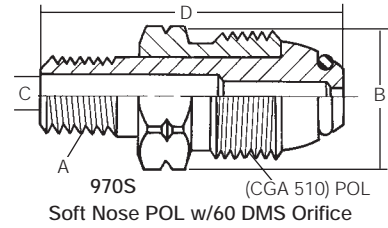
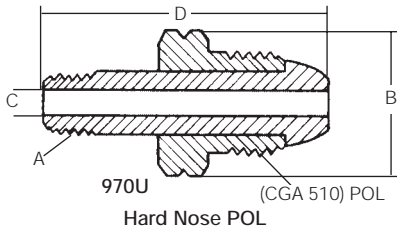

Part Number	Material	A	B Hex	C Drill	D	Closing Flow (Propane)		
						Vapor at 100 PSIG Inlet (SCFH)	Liquid (GPM)	
970U	Brass	1/4" M. NPT	7/8"	5/16"	2 3/8"	—	—	
970S				3/16"	2 3/32"			
970AX				5/16"	2 5/64"			
970AXS			1 3/8"	7/8"	3/16"	2 7/16"	450	0.95
3199W						2 3/32"	—	—
970AW								
970HT								
970JR	1/4" Hose Barb	7/8"	5/32"	2 5/8"	—	—		

Note: All nipples incorporate wrench hex section.

## CGA 555 Swivel Adapters

Part Number	Material	A	B Hex	C	D
12982	Brass	1/4" M. NPT	1 1/4"	3/16"	1 15/16"
12982G		5/16"-18NF			

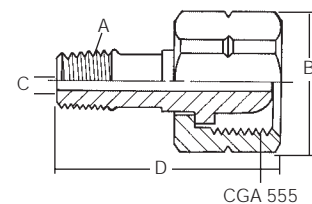

## POL Adapters

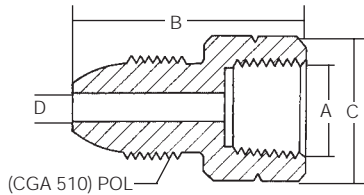

Male POL x Female NPT

### Ordering Information

Part Number	Material	A F. NPT	B	C Hex	D
2906A	Brass	1/4"	1 3/8"	1 5/16"	1/4"
2906G		1/2"	2"	1 1/8"	

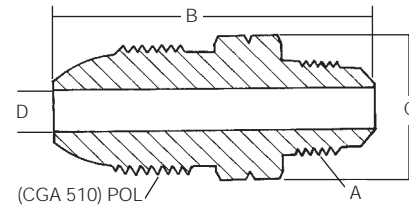

Male POL x Male NPT and SAE Flare

### Ordering Information

Part Number	Material	A	B	C Hex	D Diameter
2906D	Brass	3/8" M. NPT	2 1/16"	1 5/16"	1 1/32"
2906F		3/8" SAE Flare		7/8"	9/32"
2906E		1/2" SAE Flare	2 1/4"		

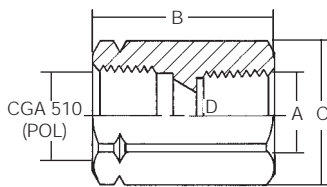

Female POL x Female NPT and Female POL

### Ordering Information

Part Number	Material	A F. NPT	B	C Hex	D Diameter
5760Z	Brass	1/8"	1 5/8"	1 1/8"	5/16"
5760A		1/4"			13/32"
5760B		3/8"			35/64"
5760C		1/2"			43/64"
5760D		3/4"			17/8"
5760S		POL (CGA 510)	2 1/8"	1 1/8"	13/32"

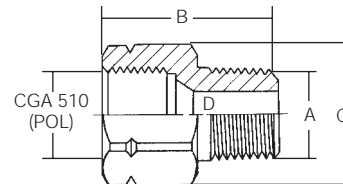

Female POL x Male NPT

### Ordering Information

Part Number	Material	A M. NPT	B	C Hex	D Diameter
5761A	Brass	1/4"	1 5/8"	1 1/8"	3/16"
5761B		3/8"			13/32"
5761C		1/2"			7/16"
5761D		3/4"			

## Miscellaneous Adapters

Hose Adapter  
For use with fuel gases (LP-Gas, Acetylene).

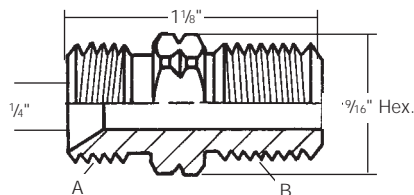

### Ordering Information

Part Number	Material	A	B
1300	Brass	9/16"-18NF (L.H.)	1/4" M. NPT

Pressure Gauge Adapter

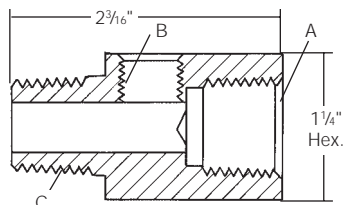

### Ordering Information

Part Number	Material	A	B	C
1494-1	Brass	1/2" F. NPT	1/4" F. NPT	1/2" M. NPT

### Ordering Information

Part Number	Material	A	B
15774-1	Brass	1/4" M. NPT	Female Inverted Flare

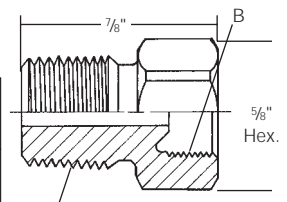

Female Inverted Flare x Male NPT

### Ordering Information

Part Number	Material	A Male	B Female	C	D	E	F
1328	Brass	5/8"-18 UNF	5/8"-18 UNF	1/2" Hose Barb	1 3/16"	2"	1 1/2"
1331		3/4"-16 UNF	3/4"-16 UNF		1 5/16"	2 1/8"	1 3/4"
1332		7/8"-14 UNF	7/8"-14 UNF		1 1/16"	2 1/2"	